



## PRECAST & PRESTRESSED CONCRETE PRODUCTS

BMI Precast has over 80 years experience in the building and concrete industry. We manufacture a wide range of precast, prestressed products from boat ramp planks to pilings, from channel beams to dolosse.

Our plant and personnel are both PCI and ACI certified, and we hold a certification with Washington State DOT. Call us today to discuss your precast, prestressed concrete needs (360) 380-2142.



# PRECAST, PRESTRESSED CONCRETE PRODUCTS

Noise Wall Panels

Channel Beams

Bulb Tees

Haunched Deck Panels

Dolosse

Boat Ramp Planks

Prestressed Bridge Decks

Pilings

Solid Concrete Deck Slabs

Laggings

And More...



**Dolosse:** Used along shorelines, the dolosse help prevent erosion by dissipating, rather than blocking, the energy, of the water. The design and positioning one on top of another ensures that the dolosse form an interlocking but porous, wall.



**Boat Ramp Planks:** Concrete boat ramp planks are widely accepted as one of the best products around. Bellingham's boat ramp planks offer a clean cut groove allowing for safe operation in all conditions. Pre-fabricated planks allow for fast installation.



**Channel Beams and Bulb Tees:** Channel beams and bulb tees are commonly used in bridge construction. Bellingham's factory production ensures consistent quality. A variety of depths and lengths are available; we have the ability to meet custom requirements and specifications.

**BMI** | Precast

BMI Precast  
5500 Nordic Way  
Ferndale, WA 98248  
Ph. (360) 380-2142  
Fax (360) 384-8134  
bmi@bellingham-mairne.com  
www.bellingham-marine.com





## BRIDGE COMPONENTS

### PRECAST /PRESTRESSED



Bellingham Marine manufactures a wide range of precast, prestressed products for bridge construction including voided and solid slabs and girders.

Our plant and personnel are both PCI and ACI certified, and we hold a certification with Washington State DOT.

Call us today to discuss your precast, prestressed concrete needs (360) 380-2142.

# BRIDGE COMPONENTS

Girders, Deck Slabs, Piles, Channel Beams, Bulb tees, and more...



## Solid & Voided Slabs

Slab bridge decks are useful for short spans. Designed with either solid or voided slabs, BMI's deck slabs are a precast, prestressed concrete product. Typical slabs are 4' wide by 18" thick and up to 70' long.

Voided slabs feature voids extending the full length of the slab. This makes the slab much lighter than a solid slabs of equal thickness or strength.



## Bridge Girders

Precast prestressed bridge girders require minimal lead times because they are locally manufactured in standard shapes and sizes.

The precast components are easy to erect in any weather. Simple connections join the deck girders to the substructure.

## Relevant Projects

PROJECT NAME	LOCATION	CLIENT	PRODUCT	SPAN
King Co. Bridge Replacement	King County, WA	King County	4' x 18" Prestressed Solid Slabs	3 (ea) 40'
Millport Slough Bridge	Kernville, OR	Oregon DOT	12" square, 50' & 60' Piles	N/A
Schmid Road Bridge	Montesano, WA	Grays Harbor Co.	4' x 18" Prestressed Voided Slabs	33'
Prairie Creek Bridge	Thurston Co., WA	Thurston Co.	4' x 18" Prestressed Voided Slabs	62'
Johnson Creek Bridge	Whatcom Co., WA	WSDOT	4' x 18" Prestressed Voided Slabs	48.5'
Church Mountain Bridge	Bellingham, WA	WSDOT	5' x 12" Prestressed Solid Concrete Girder	34'
Ten Mile Creek	Bellingham, WA	Whatcom Co.	4' x 18" Prestressed Voided Slabs	40'
May Creek Bridge	Issaquah, WA	WSDOT	4' x 12" Prestressed Solid Slab	33'
McKay /Dairy Creek Bridge	Hillsboro, OR	Oregon DOT	4' x 18" Prestressed Voided Slabs	3 (ea) 43'
Conrad Bridge	Rockport, WA	Skagit Co.	4' x 22" Prestressed Voided Slabs	70'





## BARRIER WALL PANELS

COST-EFFECTIVE SOLUTION

Bellingham Marine has over 80 years experience in the building and concrete industry. We manufacture a wide range of precast, pre-stressed products including our popular Barrier Wall Panels.

Our plant and personnel are both PCI and ACI certified, and we hold a certification with Washington State DOT. Call us today to discuss your precast, prestressed concrete needs (360) 380-2142.



# BARRIER WALL PANELS

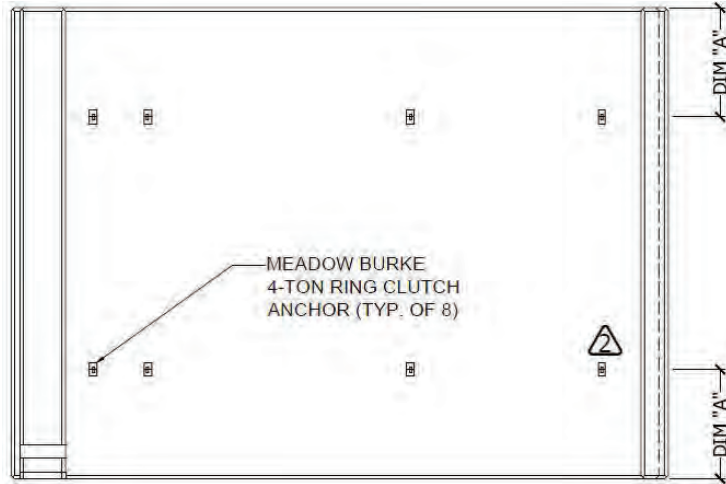

Typical view of lifting rings

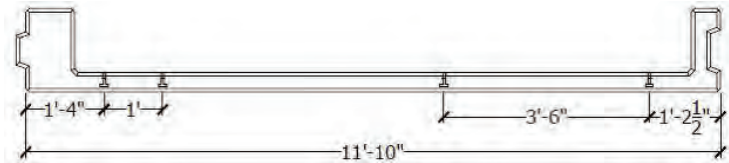

Typical view of tongue and groove

## Features

Noise walls are free-standing barriers built parallel to a highway and are found near public areas (such as parks) and residential homes. Most noise walls are included as part of large construction projects that add new lanes to highways. Long before construction begins, acoustical engineers evaluate sources and patterns of noise in neighborhoods near the project limits.

Typical precast walls range in height from 6 to 22 feet, but normally they are 12 to 15 feet tall.

**BMI** | Precast

BMI Precast  
5500 Nordic Way  
Ferndale, WA 98248  
Ph. (360) 380-2142  
Fax (360) 384-8134

bmi@bellingham-mairne.com  
www.bellingham-marine.com

## Shipping

BMI Precast uses an innovative method for shipping, which reduces the overall shipping cost. Panels are cast with lifting rings and shipped flat as pictured above.

## Options

Noise Wall Panels can be custom ordered in a range of colors and textures. Custom lengths and widths are standard. Pictured left is a wall panel with a "fractured finish".



# BARRIER WALL PROJECTS

## Lacey Noise Wall Project

Location: Lacey, WA

Owner /Date: Washington State Department of Transportation, 2011



The Noise Wall project for the WSDOT in Lacey, WA, included the fabrication of 118,180 square feet of precast wall panels. The project called for the construction of two walls measuring 3,950 feet long and 3,200 long respectively. The panels featured a fractured fin finish and tongue and groove wings. Steel base plates were cast into the base of each panel and were bolted to cast in place footings, which were previously poured. The panels for the Lacey Noise Wall Project range in height from 8 feet to 22 feet.

The project will reduce traffic noise for people living in neighborhoods along the this stretch of 1-5.

## Lundeen Parkway Barrier Wall Project

Location: Marysville, WA

Owner /Date: Washington State Department of Transportation, 2011



BMI Precast produced 21,113 square feet of Barrier Panels for the project on Lundeen Parkway in Snohomish County. Panels for this project featured a flat finish were set between steel sheet piles driven previously. The panels range in height from 8 feet to 21 feet.

The Lundeen Parkway Noise Wall Project is part of a major reconstruction effort to improve safety and reduce congestion on SR9 between Lundeen Parkway and SR 92 by widening the road and adding lanes.